



Morgans

PROPERTY

23 Whinfield Drive, Kinross, KY13 8UB

Offers Over £270,000











**\*\* £10,000 Under Home Report \*\*** 23 Whinfield Drive is a delightful detached bungalow ideally situated in a sought after cul de sac in Kinross. Set on a large corner plot, the property boasts wrap around gardens and a driveway leading to a single garage. Upon entering, you are welcomed into a spacious L-shaped hallway which gives access to all living and bedroom accommodation. The generous lounge/dining room is bathed in natural light thanks to the impressive floor-to-ceiling windows and French doors. This feature not only enhances the sense of space but also provides a seamless connection to the garden, making it an ideal setting for both relaxation and entertaining. The kitchen is a good sized room with window to the front and space for a breakfasting table and chairs. The bungalow comprises three well-proportioned bedrooms, each offering a tranquil retreat for rest and relaxation. The modern shower room is tastefully designed, ensuring convenience and style for everyday living. This property is perfect for those seeking a peaceful lifestyle, while still being close to local amenities. With its spacious layout, this bungalow is a wonderful opportunity for families, retirees, or anyone looking to enjoy the benefits of single-storey living. Don't miss the chance to make this lovely home your own.

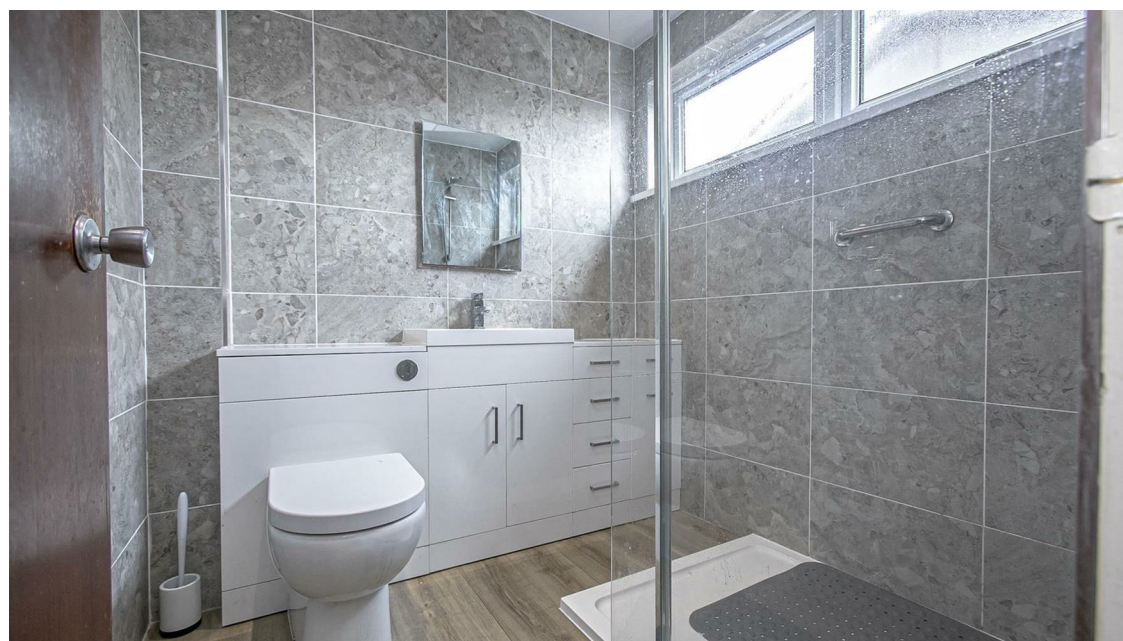





#### OUTSIDE SPACE

Externally this property has driveway parking to the front leading to a single garage. The garage has power and light and a rear door leading to the garden. The rear garden is fully enclosed with patio seating area, lawn and separate drying area.

#### EXTRAS INCLUDED IN THE SALE

All fitted floor coverings and light fittings will be included in the sale.

#### VIEWINGS

All viewings are strictly by appointment by calling Morgans on 01577 863424.

#### MORGANS PROPERTY PACKAGE

We provide the complete buying and selling package including a comprehensive estate agency service and full legal service. For a FREE PRE-SALE VALUATION, estimate and market appraisal without cost or obligation, please contact us.









23 Whinfield Drive, Kinross, KY13 8UB

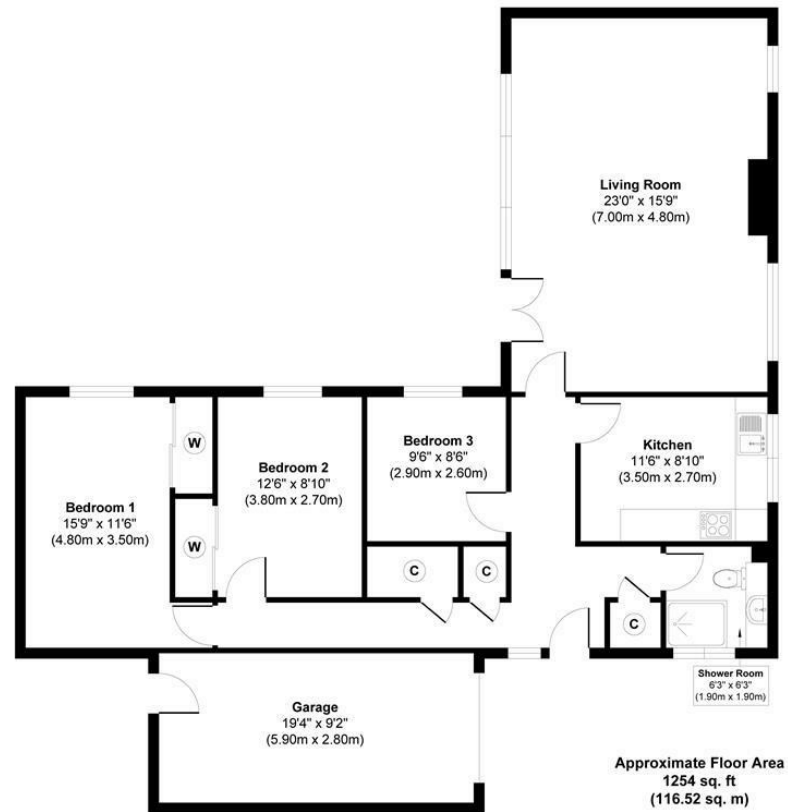

Morgans

PROPERTY

Approx. Gross Internal Floor Area 1254 sq. ft / 116.52 sq. m

Illustration for identification purposes only. measurements approximate, not to scale. Copyright

Morgans

PROPERTY

SOLICITORS | PROPERTY

62 High Street, Kinross, KY13 8AN

Tel: 01577 863424

[www.morganlaw.co.uk](http://www.morganlaw.co.uk)



espc

s1homes.com

rightmove

Zoopa.co.uk

onTheMarket.com

naea | propertymark  
PROTECTED

AGENTS NOTE These particulars do not form part of any contract and the statements or plans contained herein are not warranted nor to scale. Approximate measurements have been taken by electronic device at the widest point. Services and appliances have not been tested for efficiency or safety and no warranty is given as to their compliance with any Regulations. No movable items will be included in the sale.